



DISTINCTIVE CATERING VENUES

mill city museum



contemporary meets industrial

SINCE 1995

Unique spaces for private dining



JODI ANN

MILL COMMONS



SEWELL

OUTDOOR COURTYARD



NOAH WOLF

HEAD TABLE

COMPLETE PHOTO LIBRARY AT [FLICKR.COM/DAMICOCATERING](https://www.flickr.com/photos/damicocatering/)



VENUE : **MILL CITY MUSEUM**

VENUE DETAILS

LOCATION & CONTACT

Phone: 612.238.4444
Fax: 612.238.4040
Website: www.damicocatering.com

D'Amico Catering at
Mill City Museum
704 South 2nd Street
Minneapolis, MN 55401

CAPACITIES/SPACE*	THEATER	RECEPTION	BUFFET	PLATED	SQUARE FEET
MILL COMMONS AND RAIL CORRIDOR	250	400	230	250	7200
RUINS COURTYARD	250	300	100	150	10000
EXTERIOR RAIL CORRIDOR	200	500	200	250	10800
ADM ROOM	40	60	20	24	900
710 ROOM	N/A	N/A	10	10	350
CLASSROOM	50	75	36	42	925

*Capacities are only a guide and are approximate

The striking Mill City Museum rises from the ruins of the Washburn A Flour Mill, a National Historic Landmark. Major renovations began in 2001 to bring this 120-year old building into the 21st century. The award-winning architectural design combines relics of the mill's past with modern steel, brick and wood to create a contemporary, industrial space that beautifully preserves the building's historic integrity. Weathered masonry walls frame a delightfully unpretentious 100 x 100 foot courtyard, and other spaces in the building boast a similarly industrial feel—and can accommodate up to 500 guests. For all its raw authenticity, the Mill City Museum is a modern charmer.

AMENITIES

- House Sound System
- Audio-Visual Services
- Professional Event Managers
- Stunning Outdoor Courtyard
- Riverfront Views
- Interactive Museum Gallery
- Handicapped Accessible
- Adjoining Riverfront Park
- Award Winning Flour Tower Experience
- Museum Gift Store
- Movie: Minneapolis in 19 Minutes
- Ample Parking and Optional Valet Services
- Award Winning D'Amico Cuisine
- Outdoor Patio Furniture
- Covered Outdoor Space
- Located in Vibrant Warehouse District
- Walking Distance to Nearby Hotels
- History Players: Pat O'Butter, William de la Barre, Franklin Steele

BOOKING GUIDELINES

Tours: Given by D'Amico, call to schedule
Rental Fee: Varies, call for pricing
Availability: Daily, Day and Evening Events
Floor Plans: Custom designed by D'Amico
Bar: Cash and Hosted (Open Bar) allowed

COMPLIMENTARY TABLES AND CHAIRS

(Limited Quantities Available)

- 48" x 84" Oval Tables
- 3' x 3' Square Café Tables
- 30" High and Low Cocktail Tables
- 3' x 30" Rectangular Tables
- 4' x 30" Rectangular Tables
- Black Chairs (33.5" h x 17" w)
- 6' x 30" Serpentine Tables
- Metal Chairs (36" h x 15.5" w)
- 8' x 30" Rectangular Tables
- Wooden White Folding Chairs available for rental for ceremonies (30" h x 17.5" w)

VENUE : MILL CITY MUSEUM

FLOOR PLAN

EVENT : WEDDING RECEPTION

GUEST CAPACITY: 220

TABLES:

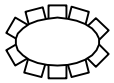

20 OVALS OF 10 SEATS

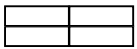

HEAD TABLE FOR 20



HIGH COCKTAIL TABLES

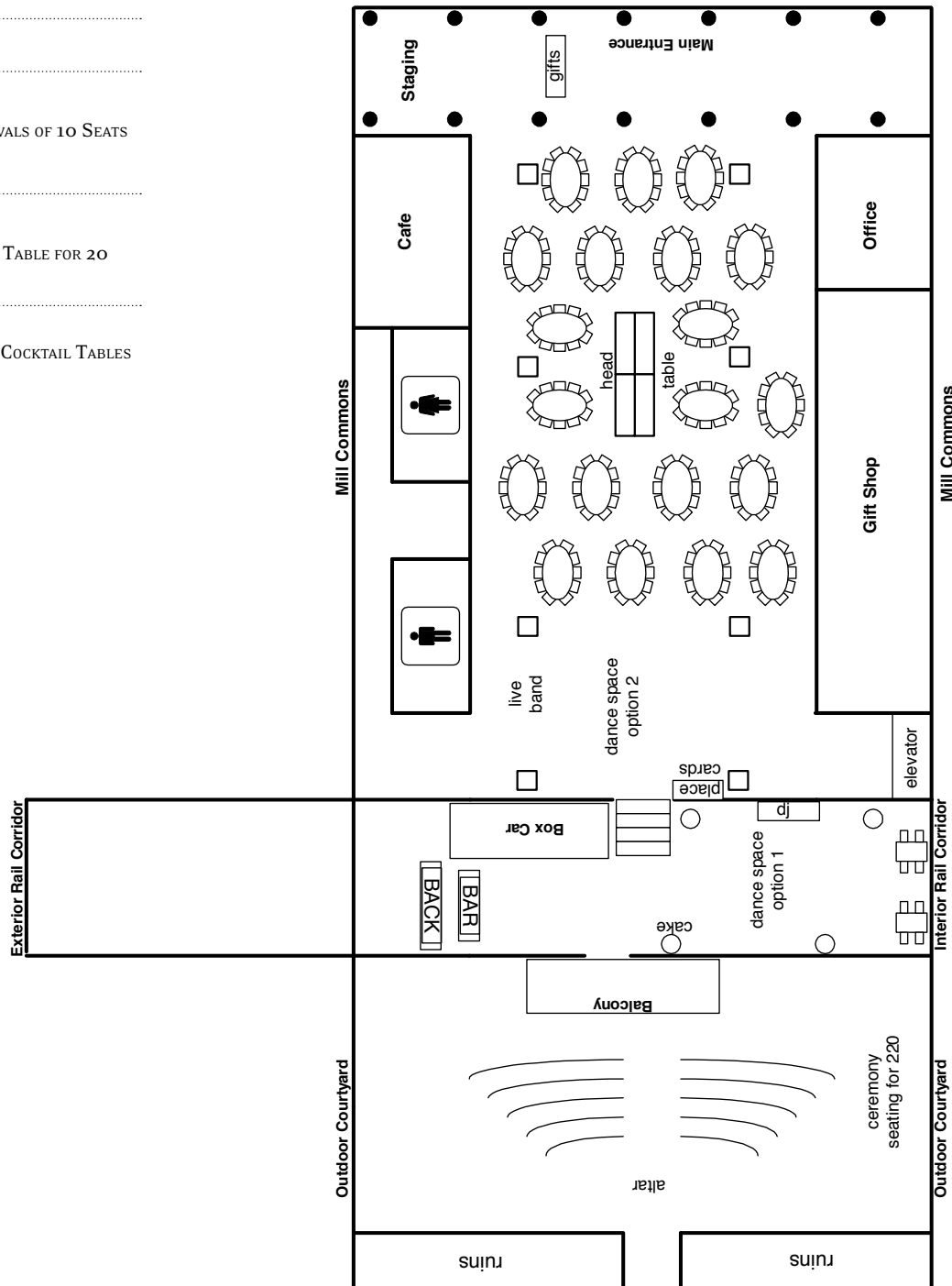

VENUE : MILL CITY MUSEUM

FLOOR PLAN

EVENT : PLATED DINNER

GUEST CAPACITY: 250

TABLES:

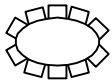

25 OVALS OF 10 SEATS



HIGH COCKTAIL TABLES



LOW COCKTAIL TABLES

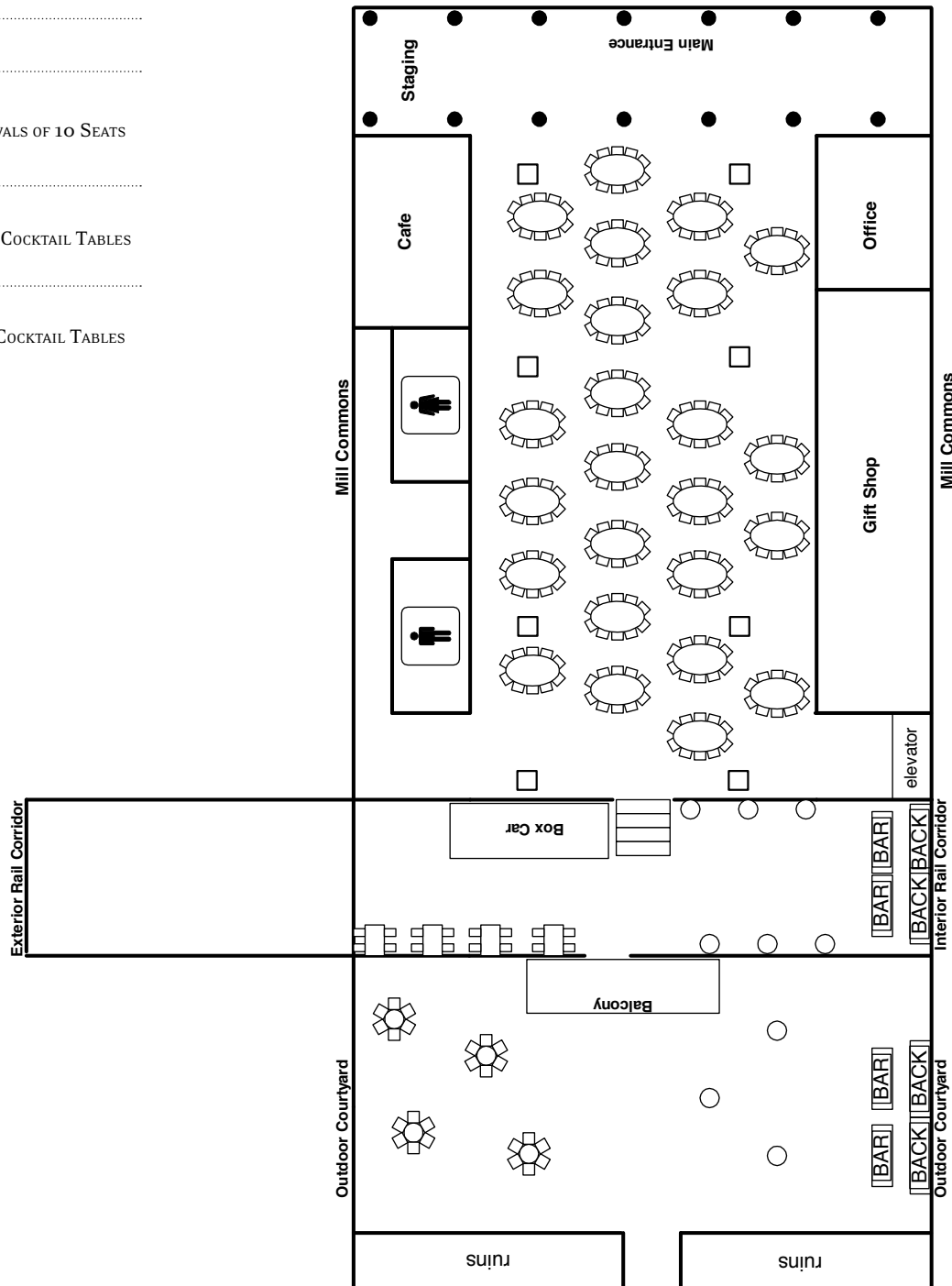

VENUE : MILL CITY MUSEUM

FLOOR PLAN

EVENT : BUFFET DINNER

GUEST CAPACITY: 230

TABLES:

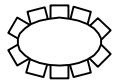

23 OVALS OF 10 SEATS



HIGH COCKTAIL TABLES



LOW COCKTAIL TABLES

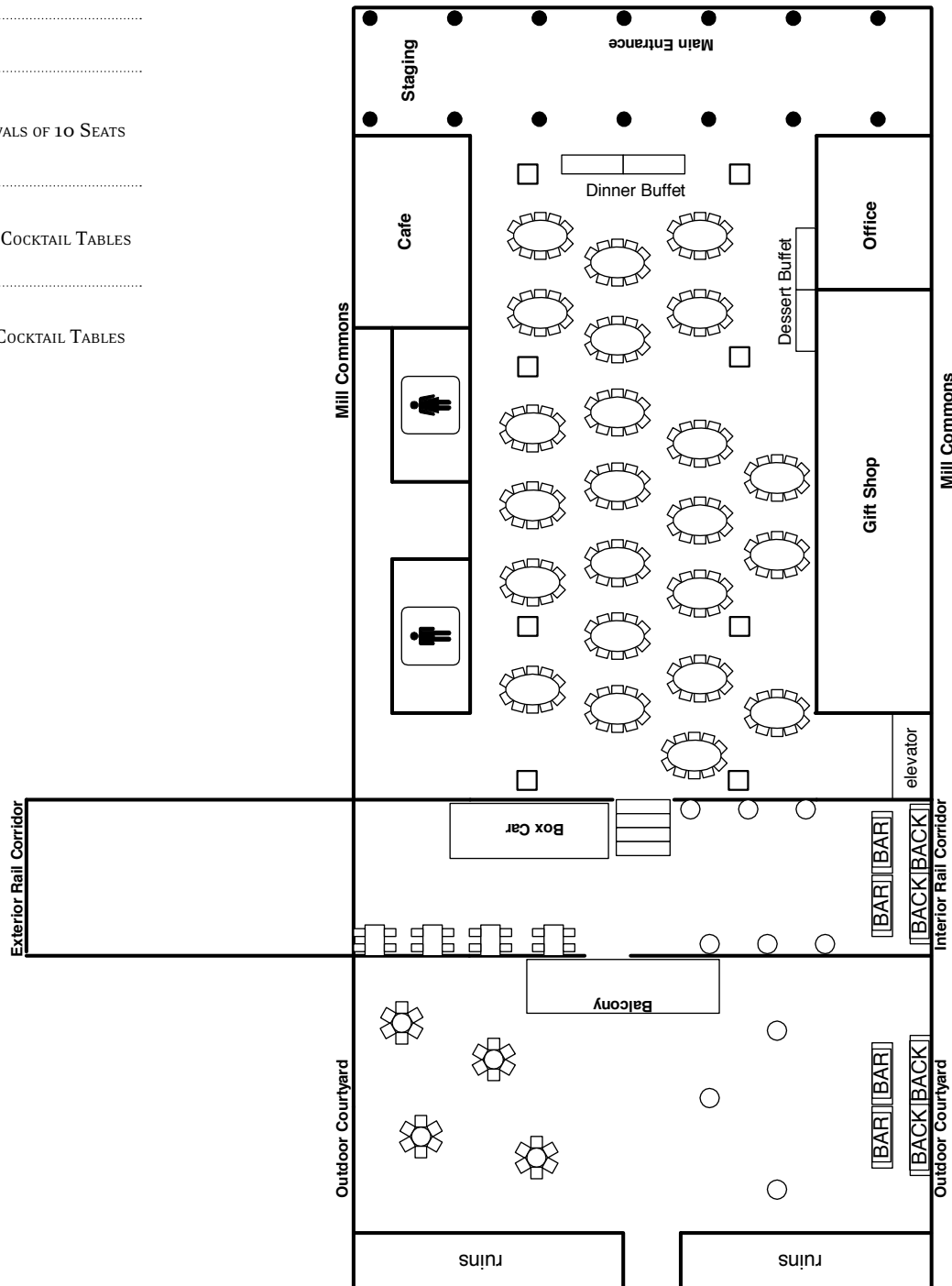

EVENT : RECEPTION

GUEST CAPACITY: 400

TABLES:

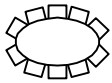

OVAL TABLE



LOW COCKTAIL TABLES



HIGH COCKTAIL TABLES

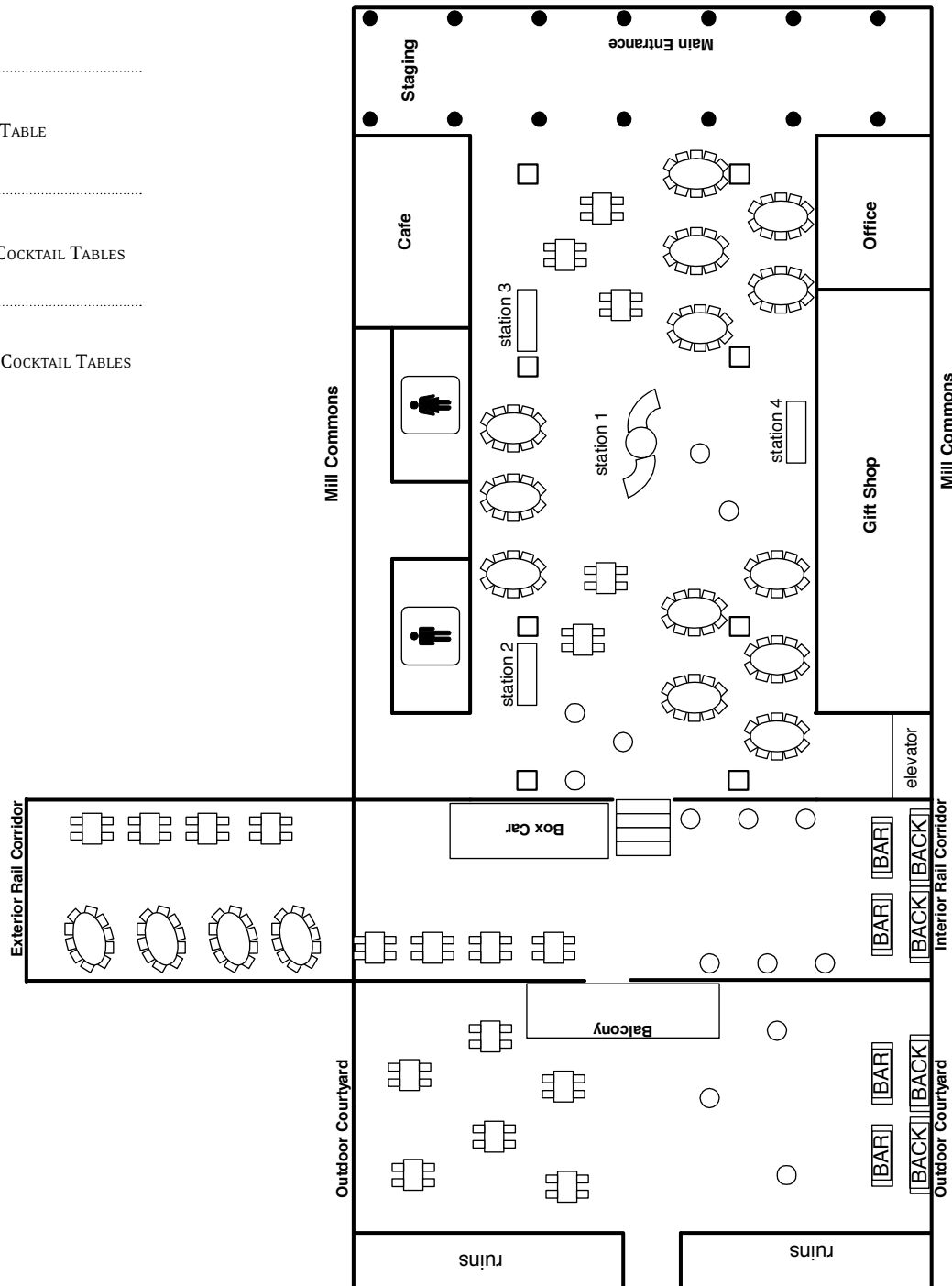

EVENT : THEATER STYLE

GUEST CAPACITY: 240

TABLES:



LOW COCKTAIL TABLES



HIGH COCKTAIL TABLES

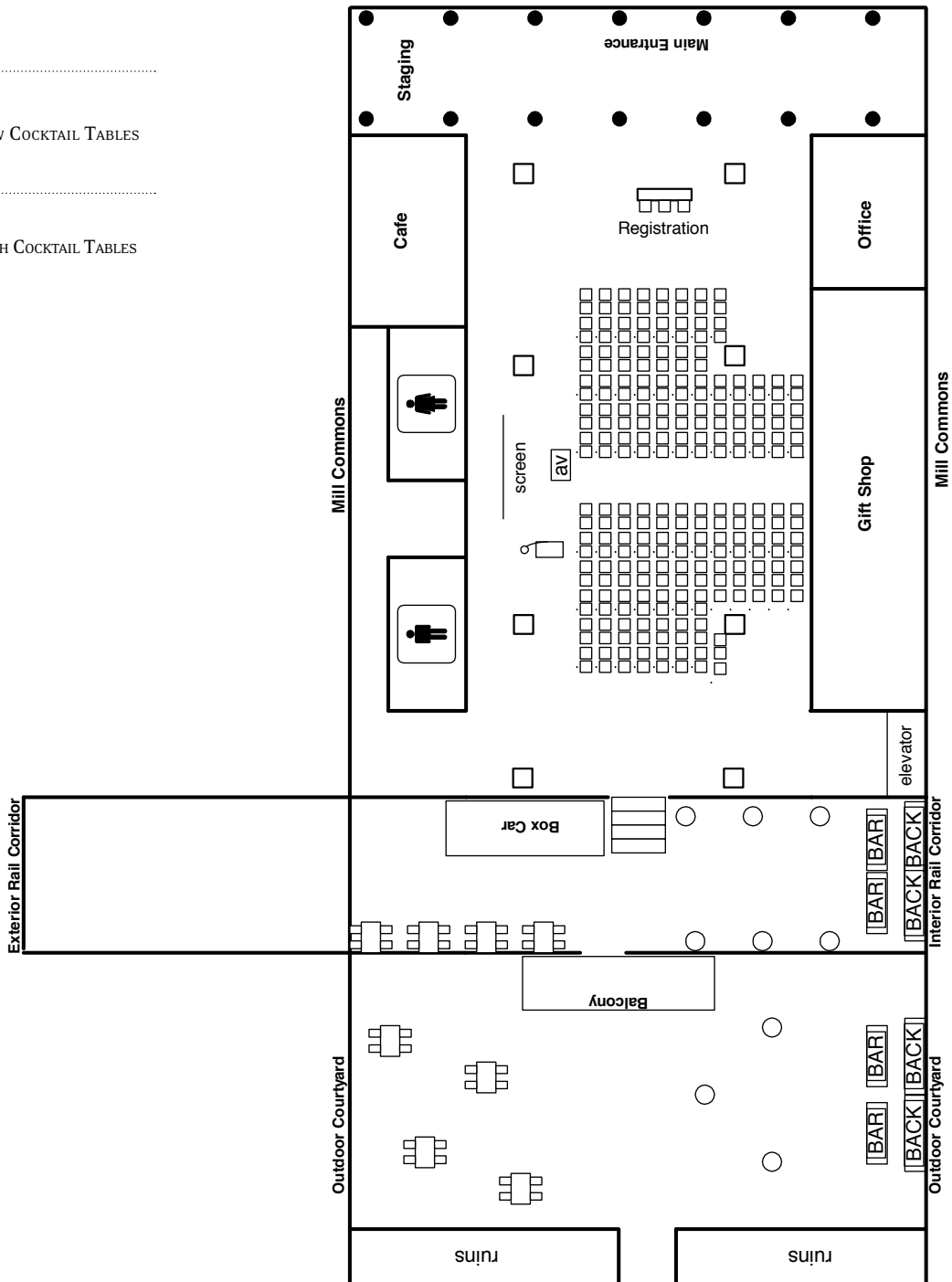

EVENT : **FUNDRAISER**

GUEST CAPACITY: **180**

TABLES:

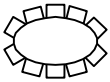

18 OVALS OF 10 SEATS



9 AUCTION TABLES



HIGH COCKTAIL TABLES



LOW COCKTAIL TABLES

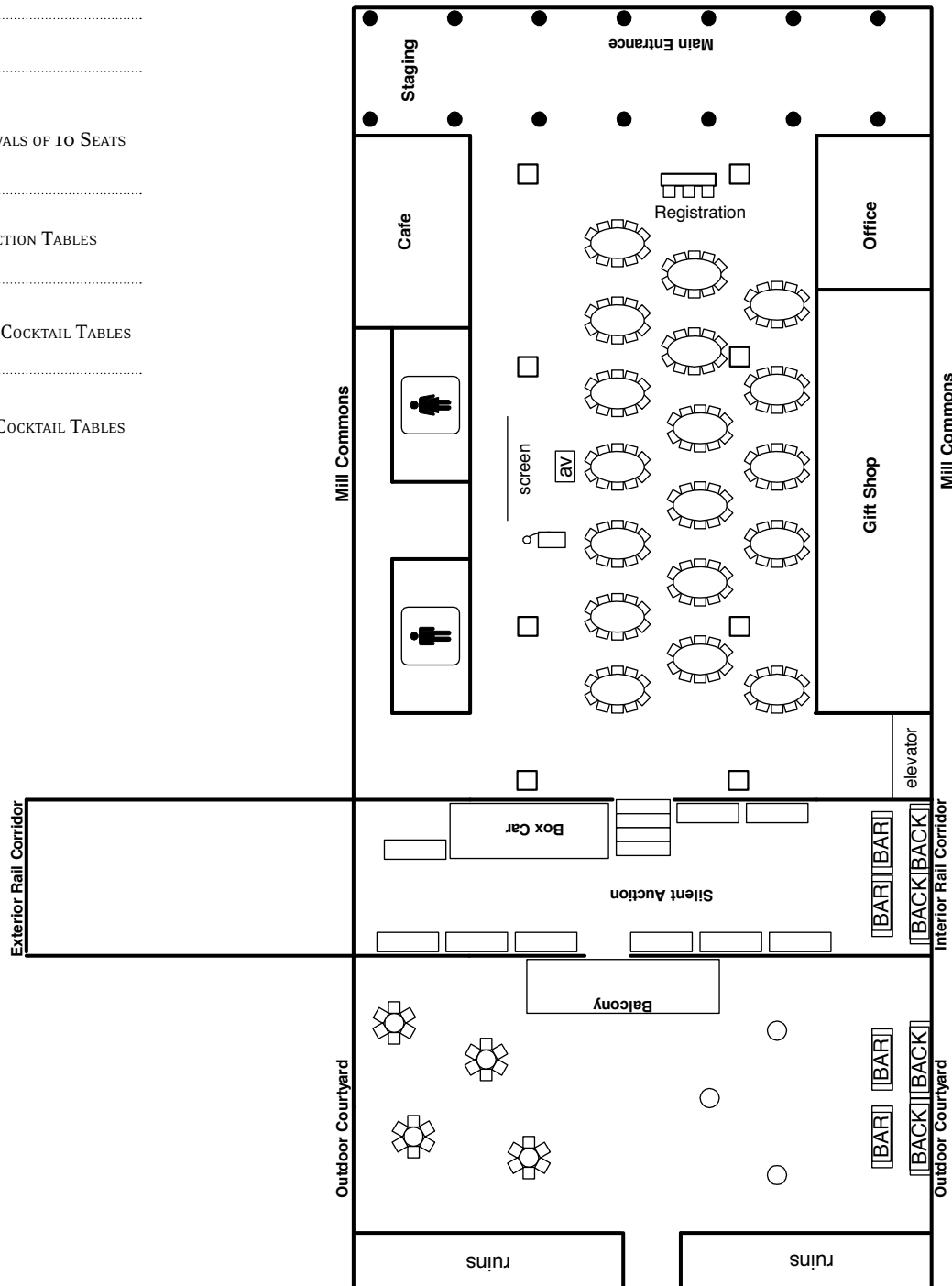

VENUE: **MILL CITY MUSEUM**

CREDIT CARD AUTHORIZATION

OFFICE USE ONLY

EO # _____
VENUE _____



D'AMICO
CATERING

*** CREDIT CARD AUTHORIZATION FORM ***

I GIVE AUTHORIZATION TO D'AMICO CATERING TO CHARGE MY DEBIT or CREDIT CARD TO
PAY FOR:

Name of Event: _____

Date of Event: _____

D'Amico Catering Event Planner: _____

DEBIT CARD (circle one): Visa Am Ex Discover Mastercard

Card Number: _____

Expiration Date: _____

Daily Limit: _____

CREDIT CARD (circle one): Visa Am Ex Discover Mastercard

Card Number: _____

Expiration Date: _____

Name (as it appears on card): _____

Statement Billing Address: _____

Zip Code: _____

Signature of Card Holder: _____

Date: _____

CARD TO BE USED FOR: Deposit Pre-Payment & Final Payment
(circle all that apply)

Specific Amount:
(if known) _____

YOUR SIGNATURE ABOVE CONFIRMS YOUR AGREEMENT TO ALLOW D'AMICO CATERING TO CHARGE THE CREDIT CARD ABOVE FOR YOUR EVENT. IF NO OTHER FORM OF PAYMENT IS PROVIDED PRIOR TO DATE OF EVENT, AND D'AMICO HAS NOT BEEN ADVISED OTHERWISE, ANY OUTSTANDING CHARGES FOR YOUR EVENT WILL BE CHARGED TO THE CARD ABOVE. IF A REFUND IS ISSUED IT WILL BE APPLIED TO THE CARD WITH THE HIGHEST DOLLAR AMOUNT CHARGED UNLESS A SPECIFIED CARD IS CHOSEN.

**** A FAX COPY OF THIS AUTHORIZATION SHALL BE AS VALID AS THE ORIGINAL ****

Please return this form to D'Amico Catering Fax: (612) 238-4040/Tel: (612) 238-4444

VENUE: **MILL CITY MUSEUM**

FLOOR PLAN

LOCATION AND CONTACT:

D'Amico Catering at the
Mill City Museum
704 South Second Street
Minneapolis, MN 55401

Phone: 612.238.4444
Fax: 612.238.4040

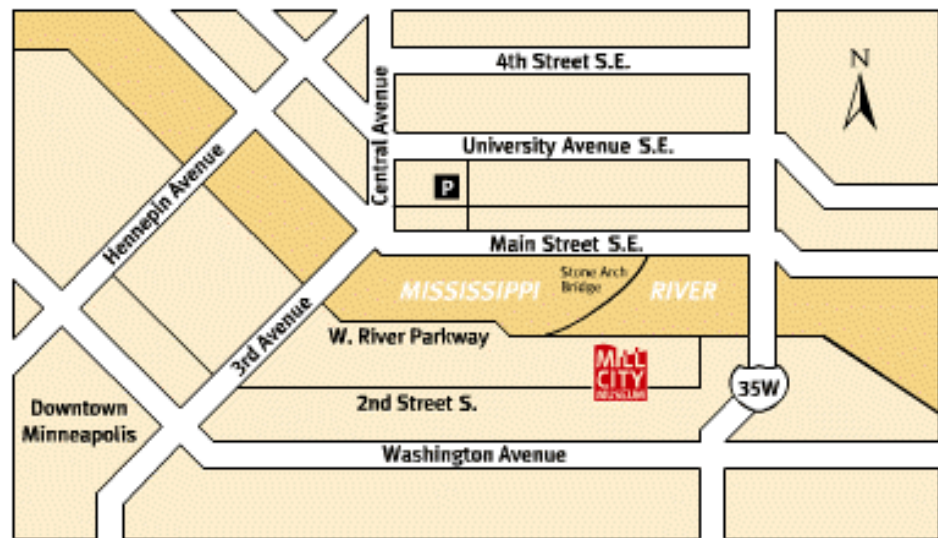

DIRECTIONS TO MILL CITY MUSEUM

Mill City Museum is located in downtown Minneapolis on the west bank of the Mississippi River, just north of the Hubert H. Humphrey Metrodome, near the corner of Park Avenue and 2nd Street.

Look for the Gold Medal Flour sign. The museum is right next door.

VIA LIGHT RAIL FREE Park and Ride from Ft. Snelling. 18 minutes to Downtown East/Metrodome Station. Walk west 1/2 block to Park Avenue, north on Park Avenue 4 short blocks.

FROM THE SOUTH Take I-35W north to the 3rd Street/University Avenue exit #17C. Follow sign for West Bank. Turn left onto Washington Avenue. Turn right onto Park Avenue. Mill City Museum will be directly ahead to the right.

FROM THE NORTH Take I-35W south to the Washington Avenue exit #17C. Turn right onto Washington Avenue. Turn right onto Park Avenue. Mill City Museum will be directly ahead to the right.

FROM NORTH WEST Take I-94 east to the 4th Street North exit #230. Follow 4th Street to Park Avenue and turn left, cross Washington Avenue, Mill City Museum will be directly ahead to the right.

FROM THE WEST Take I-394 east to the Washington Avenue exit #9C. Turn right on Washington to Park Avenue. Turn left on Park Avenue. Mill City Museum will be directly ahead to the right.

FROM THE EAST Take I-94 west to the 5th street exit #234B. Go right on 11th Avenue, cross Washington and take the first left turn onto South Second Street. The museum will be on your right.

PARKING

Mill City Museum does not have its own parking lot or ramp. However there are many parking options available.

Mill Quarter Ramp is located at 711 South Second Street. The fully automated ramp accepts cash and credit cards for daily parking. Parking fees start at \$6. Fees increase during Vikings games and Guthrie Theater performances.

There is a surface parking lot directly across from our main entrance on 2nd street. Parking fees start at \$5. Fees increase during Vikings games and Guthrie Theater performances. Cash or Check only in self-service drop box. There are a limited number of city parking meters outside our main entrance on 2nd street and on the surrounding blocks (\$1.00 per hour, 2 hour limit).